

POLARIZATION MANAGEMENT MODULES

Polarization Switch – PolaSwitch™



General Photonics' all solid-state polarization switch can quickly and repeatably rotate the SOP of incoming light by a fixed angle, either 45 or 90 degrees. Both single mode and PM fiber pigtailed versions are available. With the PM option, the device functions as a TE to TM converter, switching the SOP between being aligned with the slow and fast axes of the PM fiber, or between the slow axis and 45 degrees from the slow axis. With the SM option, the device simply rotates the polarization ellipse either 45 or 90 degrees. The device can be used for PMD monitoring, polarization modulation, polarization detection, and polarization metrology.

Specifications:

| | |
|--|--|
| Operating Wavelength | 1550 ± 30 nm |
| Polarization Rotation (@1550 nm, 23 °C) | 45 ± 0.5°, or 90 ± 0.5° |
| Polarization Rotation (All Wavelengths, All Temp.) | 45 ± 5°, or 90 ± 5° |
| Insertion Loss | < 0.5 dB |
| Return Loss | > 55 dB |
| Switching Current | < 130 mA |
| Switching Voltage | 3.5 ~ 5 V |
| Latching Current | ~ 80 mA |
| Latching Voltage | 2 ~ 3 V |
| Switching Time | 100 μs typical |
| Extinction Ratio | > 18 dB for PM model |
| Operating Temperature | 0 ~ 50 °C |
| Storage Temperature | -40 ~ 85 °C |
| Fiber Type | PM Panda, Corning SMF-28 or compatible |
| Dimensions | 1.57" (L) x 0.69" (W) x 0.53" (H) |

Features:

- Fast
- No moving parts
- Low insertion loss
- Compact

Applications:

- Polarization diversified detectors and sensors
- Polarization multiplexing
- Polarization metrology
- Polarization modulator
- Coherent communication
- PMD monitoring

Tech Info: p. 152
FAQ: p. 180

Note: Values are referenced without connectors.

Dimensions (in inches):

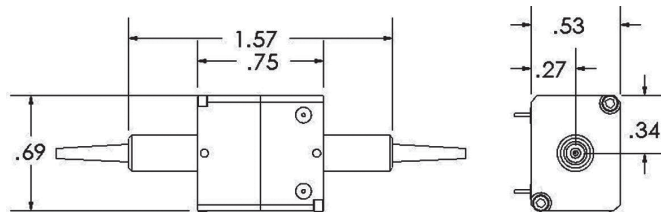

Ordering Information:

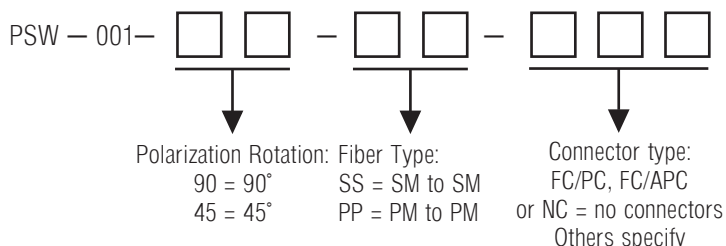

光貿易株式会社
〒113-0034
東京都文京区湯島 3-13-8 湯島不二ビル 301号
TEL : 03-3832-3117 FAX : 03-3832-3118
e-mail : contact@hikari-trading.com
http://www.hikari-trading.com/